

PL-CORE-G7 3000-830 L15 H1

PrevaLED Core G7 L15 H1 | Spot-, Down- and Wallmount Light Engines and Modules



A termék jellemzői

- Complete portfolio with varying luminous flux, color temperature, color rendering
- Available with color temperature: 2,700 K, 3,000 K, 3,500 K or 4,000 K
- OEM Programmable with 1mA resolution to perfectly match LED load and maximize performance

A termék előnyei

- High driver flexibility allows cost-effective and intelligent systems
- 5 year guarantee

Alkalmazási területek

- Spotlighting in shops and retail
- Down- and wall lighting in offices, corridors, meeting rooms, workplaces
- Decorative and functional lighting in hospitality, hotels, restaurants
- Functional lighting in public and commercial buildings



Termék adatlap

Műszaki adatok

Elektromos adatok

| | |
|---------------------|--------|
| Névleges feszültség | 35.1 V |
| Névleges áram | 0.58 A |
| Áram típusa | DC |
| On-mode power | 20 W |

Fotometriai adatok

| | |
|-----------------------|------------|
| Luminous efficacy | 148 lm/W |
| Színvisszaadási index | ≥80 |
| Fényszín (megnevezés) | Warm White |

Fénytechnikai adatok

| | |
|------------------|--------|
| Gyújtási idő | 0.0 s |
| Bemelegedési idő | 0.00 s |

Méreték és súly

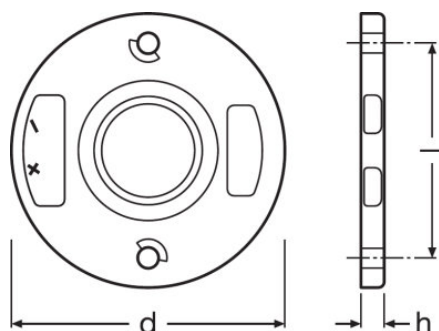

| | |
|--------------|---------|
| Termék súlya | 6.00 g |
| Átmérő | 44.0 mm |

Hőmérséklet és működési feltételek

| | |
|--|--------------|
| Működési hőmérséklet IEC 62717 szerint | 65 °C |
| Max. hőmérséklet a tc mérőponton | 100 °C |
| Környezeti hőmérséklet tartomány | -20...+50 °C |
| Hőmérséklet-tartomány tároláskor | -20...60 °C |

Élettartam

| | |
|---------------------------|--------|
| Kapcsolási ciklusok száma | 100000 |
|---------------------------|--------|

További termékadatok

| | |
|-----------------------|--|
| Product remark | Modules perfectly matched to OSRAM OPTOTRONIC LED drivers (see relevant table)/For current photometric data and important safety, installation and application information (see www.osram.com/led-systems)/All the technical parameters apply to the entire module. In view of the complex manufacturing process for light emitting diodes, the typical values given above for the technical LED parameters are merely statistical values that do not necessarily correspond to the actual technical parameters of an individual product; individual products may vary from the typical values/Tolerance for optical and electrical data: +/-10% |
|-----------------------|--|

Tanúsítványok és szabványok

| | |
|-------------------------|---------|
| Szabványok | CE/ENEC |
| Védettség típusa | IP20 |

Logisztikai adatok

| | |
|-----------------------|--------------|
| Commodity code | 854141000000 |
|-----------------------|--------------|

Environmental information







| | |
|--|------------------------------------|
| Information according Art. 33 of EU Regulation (EC) 1907/2006 (REACH) | |
| Date of Declaration | 18-04-2022 |
| Primary Article Identifier | 4052899534483 |
| Candidate List Substance 1 | No declarable substances contained |
| Declaration No. in SCIP database | No declarable substances contained |



664174_5 Year OSRAM
Guarantee (LED)

Termék adatlap

Download Data

| File | |
|---|--|
|  | Addon Technical Information PrevaLED Core G7 Overview |
|  | Certificates ENEC Certificate PL CORE G7 |
|  | Declarations of conformity PL CORE G7 CE 3610978 150322 |
|  | CAD data PL CORE G7 L15 H1 IGS 150520 |
|  | CAD data PL CORE G7 L15 H1 STEP 150520 |
|  | CAD Data 2-dim PL CORE G7 L15 H1 CAD2PDF 150520 |
|  | CAD data 3-dim PL CORE G7 L15 H1 CAD3PDF 150520 |

Ecodesign regulation information:

Separate control gear and light sources must be disposed of at certified disposal companies in accordance with Directive 2012/19/EU (WEEE) in the EU and with Waste Electrical and Electronic Equipment (WEEE) Regulations 2013 in the UK. For this purpose, collection points for recycling centres and take-back systems (CRSO) are available from retailers or private disposal companies, which accept separate control gear and light sources free of charge. In this way, raw materials are conserved and materials are recycled.

Logisztikai adatok

| Termékkód | Termékmegnevezés | Csomagolás (darab/egység) | Méreték (hosszúság x szélesség x magasság) | Térfogat | Bruttó súly |
|---------------|-------------------------------|---------------------------|--|----------------------|-------------|
| 4052899534483 | PL-CORE-G7 3000-830 L15 H1 | Karton 40 | 375 mm x 263 mm x 38 mm | 3.75 dm ³ | 807.00 g |

The mentioned product code describes the smallest quantity unit which can be ordered. One shipping unit can contain one or more single products. When placing an order, for the quantity please enter single or multiples of a shipping unit.

References / Links

For more information on the multi-level guarantee and the terms and conditions of the guarantee visit

▶ www.osram.com/system-guarantee

Termék adatlap

Lemondás

Subject to change without notice. Errors and omission excepted. Always make sure to use the most recent release.