

PrevaLED Core G7 L15 H1

Spot-, Down- and Wallmount Light Engines and Modules



A termék jellemzői

- Complete portfolio with varying luminous flux, color temperature, color rendering
- Available with color temperature: 2,700 K, 3,000 K, 3,500 K or 4,000 K
- OEM Programmable with 1mA resolution to perfectly match LED load and maximize performance

A termék előnyei

- High driver flexibility allows cost-effective and intelligent systems
- 5 year guarantee

Alkalmazási területek

- Spotlighting in shops and retail
- Down- and wall lighting in offices, corridors, meeting rooms, workplaces
- Decorative and functional lighting in hospitality, hotels, restaurants
- Functional lighting in public and commercial buildings



Termékcsalád adatlap

Műszaki adatok

Termékmegnevezés	Elektromos adatok					Fotomet riai adatok
	Névleges feszültség	Névleges áram	Áram típusa	On-mode power	Energy consumption in on-mode [GMS]	Luminou s efficacy
PL-CORE-G7 2000-827 L15 H1 ¹⁾	34.4 V	0.393 A	DC	13.4 W	13.4 kWh/1000h	148 lm/W
PL-CORE-G7 2000-830 L15 H1 ¹⁾	34.2 V	0.37 A	DC	12.5 W	12.5 kWh/1000h	158 lm/W
PL-CORE-G7 2000-835 L15 H1 ¹⁾	34.2 V	0.364 A	DC	12.4 W	12.4 kWh/1000h	161 lm/W
PL-CORE-G7 2000-840 L15 H1 ¹⁾	34.1 V	0.349 A	DC	11.7 W	11.7 kWh/1000h	168 lm/W
PL-CORE-G7 2000-927 L15 H1 ²⁾	34.9 V	0.465 A	DC	15.9 W	15.9 kWh/1000h	123 lm/W
PL-CORE-G7 2000-930 L15 H1 ¹⁾	34.7 V	0.437 A	DC	14.9 W	14.9 kWh/1000h	132 lm/W
PL-CORE-G7 2000-935 L15 H1 ¹⁾	34.9 V	0.465 A	DC	16 W	16 kWh/1000h	123 lm/W
PL-CORE-G7 2000-940 L15 H1 ¹⁾	34.7 V	0.438 A	DC	14.9 W	14.9 kWh/1000h	132 lm/W
PL-CORE-G7 3000-827 L15 H1 ¹⁾	35.2 V	0.608 A	DC	21.1 W	21.1 kWh/1000h	140 lm/W
PL-CORE-G7 3000-830 L15 H1 ¹⁾	35.1 V	0.58 A	DC	20 W		148 lm/W
PL-CORE-G7 3000-835 L15 H1 ¹⁾	35.2 V	0.594 A	DC	20.5 W	20.5 kWh/1000h	144 lm/W
PL-CORE-G7 3000-840 L15 H1 ¹⁾	34.8 V	0.542 A	DC	18.9 W	18.9 kWh/1000h	159 lm/W
PL-CORE-G7 3000-927 L15 H1 ²⁾	36.1 V	0.749 A	DC	27.1 W	27.1 kWh/1000h	111 lm/W
PL-CORE-G7 3000-930 L15 H1 ¹⁾	35.9 V	0.711 A	DC	24.8 W	24.8 kWh/1000h	118 lm/W
PL-CORE-G7 3000-935 L15 H1 ¹⁾	35.7 V	0.682 A	DC	23.8 W	23.8 kWh/1000h	123 lm/W
PL-CORE-G7 3000-940 L15 H1 ¹⁾	35.6 V	0.666 A	DC	23 W	23 kWh/1000h	127 lm/W
PL-CORE-G7 5000-827 L15 H1 ¹⁾	36.7 V	1.12 A	DC	40.1 W	40.1 kWh/1000h	122 lm/W
PL-CORE-G7 5000-830 L15 H1 ¹⁾	36.1 V	0.999 A	DC	35.4 W	35.4 kWh/1000h	139 lm/W
PL-CORE-G7 5000-835 L15 H1 ¹⁾	36.3 V	1.038 A	DC	36.8 W	36.8 kWh/1000h	133 lm/W
PL-CORE-G7 5000-840 L15 H1 ¹⁾	35.9 V	0.947 A	DC	33.3 W	33.3 kWh/1000h	147 lm/W
PL-CORE-G7 5000-935 L15 H1 ¹⁾	37.1 V	1.221 A	DC	44.2	44.2 kWh/1000h	110 lm/W
PL-CORE-G7 5000-940 L15 H1 ¹⁾	37.0 V	1.192 A	DC	43 W	43 kWh/1000h	113 lm/W

Termékcsalád adatlap

Termékmegnevezés	Színvisszaadási index	Correlated color temperature CCT [GMS]	Colour consistency (McAdam ellipszes) [GMS]	Useful luminous flux (Φ_{use}) [GMS]	Fénytechnikai adatok
					Gyűjtési idő
PL-CORE-G7 2000-827 L15 H1 ¹⁾	≥80	2700 K	3	1511 lm ³⁾	0.0 s
PL-CORE-G7 2000-830 L15 H1 ¹⁾	≥80	3000 K	3	1474 lm ³⁾	0.0 s
PL-CORE-G7 2000-835 L15 H1 ¹⁾	≥80	3500 K	3	1560 lm ³⁾	0.0 s
PL-CORE-G7 2000-840 L15 H1 ¹⁾	≥80	4000 K	3	1531 lm ³⁾	0.0 s
PL-CORE-G7 2000-927 L15 H1 ²⁾	≥90	2700 K	3	1507 lm ³⁾	0.0 s
PL-CORE-G7 2000-930 L15 H1 ¹⁾	≥90	3000 K	3	1512 lm ³⁾	0.0 s
PL-CORE-G7 2000-935 L15 H1 ¹⁾	≥90	3500 K	3	1491 lm ³⁾	0.0 s
PL-CORE-G7 2000-940 L15 H1 ¹⁾	≥90	4000 K	3	1533 lm ³⁾	0.0 s
PL-CORE-G7 3000-827 L15 H1 ¹⁾	≥80	2700 K	3	2284 lm ³⁾	0.0 s
PL-CORE-G7 3000-830 L15 H1 ¹⁾	≥80				0.0 s
PL-CORE-G7 3000-835 L15 H1 ¹⁾	≥80	3500 K	3	2263 lm ³⁾	0.0 s
PL-CORE-G7 3000-840 L15 H1 ¹⁾	≥80	4000 K	3	2252 lm ³⁾	0.0 s
PL-CORE-G7 3000-927 L15 H1 ²⁾	≥90	2700 K	3	2349 lm ³⁾	0.0 s
PL-CORE-G7 3000-930 L15 H1 ¹⁾	≥90	3000 K	3	2439 lm ³⁾	0.0 s
PL-CORE-G7 3000-935 L15 H1 ¹⁾	≥90	3500 K	3	2286 lm ³⁾	0.0 s
PL-CORE-G7 3000-940 L15 H1 ¹⁾	≥90	4000 K	3	2288 lm ³⁾	0.0 s
PL-CORE-G7 5000-827 L15 H1 ¹⁾	≥80	2700 K	3	3868 lm ³⁾	0.0 s
PL-CORE-G7 5000-830 L15 H1 ¹⁾	≥80	3000 K	3	3868 lm ³⁾	0.0 s
PL-CORE-G7 5000-835 L15 H1 ¹⁾	≥80	3500 K	3	3732 lm ³⁾	0.0 s
PL-CORE-G7 5000-840 L15 H1 ¹⁾	≥80	4000 K	3	3886 lm ³⁾	0.0 s
PL-CORE-G7 5000-935 L15 H1 ¹⁾	≥90	3500 K	3	3702 lm ³⁾	0.0 s
PL-CORE-G7 5000-940 L15 H1 ¹⁾	≥90	4000 K	3	3809 lm ³⁾	0.0 s

Termékmegnevezés	Bemelegedési idő	Méretek és súly		
		Termék súlya	Height [GMS]	Length [GMS]
PL-CORE-G7 2000-827 L15 H1 ¹⁾	0.00 s	6.00 g	3 mm	44 mm
PL-CORE-G7 2000-830 L15 H1 ¹⁾	0.00 s	6.00 g	3 mm	44 mm
PL-CORE-G7 2000-835 L15 H1 ¹⁾	0.00 s	6.00 g	3 mm	44 mm
PL-CORE-G7 2000-840 L15 H1 ¹⁾	0.00 s	6.00 g	3 mm	44 mm
PL-CORE-G7 2000-927 L15 H1 ²⁾	0.00 s	6.00 g	3 mm	44 mm
PL-CORE-G7 2000-930 L15 H1 ¹⁾	0.00 s	6.00 g	3 mm	44 mm
PL-CORE-G7 2000-935 L15 H1 ¹⁾	0.00 s	6.00 g	3 mm	44 mm
PL-CORE-G7 2000-940 L15 H1 ¹⁾	0.00 s	6.00 g	3 mm	44 mm
PL-CORE-G7 3000-827 L15 H1 ¹⁾	0.00 s	6.00 g	3 mm	44 mm
PL-CORE-G7 3000-830 L15 H1 ¹⁾	0.00 s	6.00 g		
PL-CORE-G7 3000-835 L15 H1 ¹⁾	0.00 s	6.00 g	3 mm	44 mm
PL-CORE-G7 3000-840 L15 H1 ¹⁾	0.00 s	6.00 g	3 mm	44 mm
PL-CORE-G7 3000-927 L15 H1 ²⁾	0.00 s	6.00 g	3 mm	44 mm
PL-CORE-G7 3000-930 L15 H1 ¹⁾	0.00 s	6.00 g	3 mm	44 mm
PL-CORE-G7 3000-935 L15 H1 ¹⁾	0.00 s	6.00 g	3 mm	44 mm

Termékcsalád adatlap

Termékmegnevezés	Bemelegedési idő	Méretek és súly		
		Termék súlya	Height [GMS]	Length [GMS]
PL-CORE-G7 3000-940 L15 H1 ¹⁾	0.00 s	6.00 g	3 mm	44 mm
PL-CORE-G7 5000-827 L15 H1 ¹⁾	0.00 s	6.00 g	3 mm	44 mm
PL-CORE-G7 5000-830 L15 H1 ¹⁾	0.00 s	6.00 g	3 mm	44 mm
PL-CORE-G7 5000-835 L15 H1 ¹⁾	0.00 s	6.00 g	3 mm	44 mm
PL-CORE-G7 5000-840 L15 H1 ¹⁾	0.00 s	6.00 g	3 mm	44 mm
PL-CORE-G7 5000-935 L15 H1 ¹⁾	0.00 s	6.00 g	3 mm	44 mm
PL-CORE-G7 5000-940 L15 H1 ¹⁾	0.00 s	6.00 g	3 mm	44 mm

Termékmegnevezés	Width [GMS]	Átmérő	Hőmérséklet és működési feltételek		
			Működési hőmérséklet IEC 62717 szerint	Max. hőmérséklet a tc mérőponton	Környezeti hőmérséklet tartomány
PL-CORE-G7 2000-827 L15 H1 ¹⁾	44 mm	44.0 mm	65 °C	100 °C	-20...+50 °C
PL-CORE-G7 2000-830 L15 H1 ¹⁾	44 mm	44.0 mm	65 °C	100 °C	-20...+50 °C
PL-CORE-G7 2000-835 L15 H1 ¹⁾	44 mm	44.0 mm	65 °C	100 °C	-20...+50 °C
PL-CORE-G7 2000-840 L15 H1 ¹⁾	44 mm	44.0 mm	65 °C	100 °C	-20...+50 °C
PL-CORE-G7 2000-927 L15 H1 ²⁾	44 mm	44.0 mm	65 °C	100 °C	-20...+50 °C
PL-CORE-G7 2000-930 L15 H1 ¹⁾	44 mm	44.0 mm	65 °C	100 °C	-20...+50 °C
PL-CORE-G7 2000-935 L15 H1 ¹⁾	44 mm	44.0 mm	65 °C	100 °C	-20...+50 °C
PL-CORE-G7 2000-940 L15 H1 ¹⁾	44 mm	44.0 mm	65 °C	100 °C	-20...+50 °C
PL-CORE-G7 3000-827 L15 H1 ¹⁾	44 mm	44.0 mm	65 °C	100 °C	-20...+50 °C
PL-CORE-G7 3000-830 L15 H1 ¹⁾	44 mm	44.0 mm	65 °C	100 °C	-20...+50 °C
PL-CORE-G7 3000-835 L15 H1 ¹⁾	44 mm	44.0 mm	65 °C	100 °C	-20...+50 °C
PL-CORE-G7 3000-840 L15 H1 ¹⁾	44 mm	44.0 mm	65 °C	100 °C	-20...+50 °C
PL-CORE-G7 3000-927 L15 H1 ²⁾	44 mm	44.0 mm	65 °C	100 °C	-20...+50 °C
PL-CORE-G7 3000-930 L15 H1 ¹⁾	44 mm	44.0 mm	65 °C	100 °C	-20...+50 °C
PL-CORE-G7 3000-935 L15 H1 ¹⁾	44 mm	44.0 mm	65 °C	100 °C	-20...+50 °C
PL-CORE-G7 3000-940 L15 H1 ¹⁾	44 mm	44.0 mm	65 °C	100 °C	-20...+50 °C
PL-CORE-G7 5000-827 L15 H1 ¹⁾	44 mm	44.0 mm	65 °C	100 °C	-20...+50 °C
PL-CORE-G7 5000-830 L15 H1 ¹⁾	44 mm	44.0 mm	65 °C	100 °C	-20...+50 °C
PL-CORE-G7 5000-835 L15 H1 ¹⁾	44 mm	44.0 mm	65 °C	100 °C	-20...+50 °C
PL-CORE-G7 5000-840 L15 H1 ¹⁾	44 mm	44.0 mm	65 °C	100 °C	-20...+50 °C
PL-CORE-G7 5000-935 L15 H1 ¹⁾	44 mm	44.0 mm	65 °C	100 °C	-20...+50 °C
PL-CORE-G7 5000-940 L15 H1 ¹⁾	44 mm	44.0 mm	65 °C	100 °C	-20...+50 °C

Termékmegnevezés	Hőmérséklet-tartomány tároláskor	Élettartam		Tanúsítványok és szabványok
		Kapcsolási ciklusok száma	Lumen maintenance factor LMF [GMS]	Szabványok
PL-CORE-G7 2000-827 L15 H1 ¹⁾	-20...60 °C	100000	96	CE/ENEC
PL-CORE-G7 2000-830 L15 H1 ¹⁾	-20...60 °C	100000	96	CE/ENEC
PL-CORE-G7 2000-835 L15 H1 ¹⁾	-20...60 °C	100000	96	CE/ENEC
PL-CORE-G7 2000-840 L15 H1 ¹⁾	-20...60 °C	100000	96	CE/ENEC

Termékcsalád adatlap

Termékmegnevezés	Hőmérséklet-tartomány tároláskor	Élettartam		Tanúsítványok és szabványok
		Kapcsolási ciklusok száma	Lumen maintenance factor LMF [GMS]	Szabványok
PL-CORE-G7 2000-927 L15 H1 ²⁾	-20...60 °C	100000	96	CE/ENEC
PL-CORE-G7 2000-930 L15 H1 ¹⁾	-20...60 °C	100000	96	CE/ENEC
PL-CORE-G7 2000-935 L15 H1 ¹⁾	-20...60 °C	100000	96	CE/ENEC
PL-CORE-G7 2000-940 L15 H1 ¹⁾	-20...60 °C	100000	96	CE/ENEC
PL-CORE-G7 3000-827 L15 H1 ¹⁾	-20...60 °C	100000	96	CE/ENEC
PL-CORE-G7 3000-830 L15 H1 ¹⁾	-20...60 °C	100000		CE/ENEC
PL-CORE-G7 3000-835 L15 H1 ¹⁾	-20...60 °C	100000	96	CE/ENEC
PL-CORE-G7 3000-840 L15 H1 ¹⁾	-20...60 °C	100000	96	CE/ENEC
PL-CORE-G7 3000-927 L15 H1 ²⁾	-20...60 °C	100000	96	CE/ENEC
PL-CORE-G7 3000-930 L15 H1 ¹⁾	-20...60 °C	100000	96	CE/ENEC
PL-CORE-G7 3000-935 L15 H1 ¹⁾	-20...60 °C	100000	96	CE/ENEC
PL-CORE-G7 3000-940 L15 H1 ¹⁾	-20...60 °C	100000	96	CE/ENEC
PL-CORE-G7 5000-827 L15 H1 ¹⁾	-20...60 °C	100000	96	CE/ENEC
PL-CORE-G7 5000-830 L15 H1 ¹⁾	-20...60 °C	100000	96	CE/ENEC
PL-CORE-G7 5000-835 L15 H1 ¹⁾	-20...60 °C	100000	96	CE/ENEC
PL-CORE-G7 5000-840 L15 H1 ¹⁾	-20...60 °C	100000	96	CE/ENEC
PL-CORE-G7 5000-935 L15 H1 ¹⁾	-20...60 °C	100000	96	CE/ENEC
PL-CORE-G7 5000-940 L15 H1 ¹⁾	-20...60 °C	100000	96	CE/ENEC

Termékmegnevezés	Energy efficiency class [GMS]	Logisztikai adatok	Environmental information Information according Art. 33 of EU Regulation (EC) 1907/2006 (REACH)	
		Commodity code	Date of Declaration	Primary Article Identifier
PL-CORE-G7 2000-827 L15 H1 ¹⁾	E	854141000000	18-04-2022	4052899534308
PL-CORE-G7 2000-830 L15 H1 ¹⁾	E	854141000000	18-04-2022	4052899534322
PL-CORE-G7 2000-835 L15 H1 ¹⁾	D	854141000000	18-04-2022	4052899534346
PL-CORE-G7 2000-840 L15 H1 ¹⁾	D	854141000000	18-04-2022	4052899534360
PL-CORE-G7 2000-927 L15 H1 ²⁾	F	854141000000	18-04-2022	4052899534384
PL-CORE-G7 2000-930 L15 H1 ¹⁾	E	854141000000	18-04-2022	4052899534407
PL-CORE-G7 2000-935 L15 H1 ¹⁾	F	854141000000	18-04-2022	4052899534421
PL-CORE-G7 2000-940 L15 H1 ¹⁾	E	854141000000	18-04-2022	4052899534445
PL-CORE-G7 3000-827 L15 H1 ¹⁾	E	854141000000	18-04-2022	4052899534469
PL-CORE-G7 3000-830 L15 H1 ¹⁾		854141000000	18-04-2022	4052899534483
PL-CORE-G7 3000-835 L15 H1 ¹⁾	E	854141000000	18-04-2022	4052899534506
PL-CORE-G7 3000-840 L15 H1 ¹⁾	E	854141000000	10-05-2022	4052899534520
PL-CORE-G7 3000-927 L15 H1 ²⁾	F	854141000000	18-04-2022	4052899534544
PL-CORE-G7 3000-930 L15 H1 ¹⁾	F	854141000000	18-04-2022	4052899534568
PL-CORE-G7 3000-935 L15 H1 ¹⁾	F	854141000000	18-04-2022	4052899534582
PL-CORE-G7 3000-940 L15 H1 ¹⁾	F	854141000000	18-04-2022	4052899534605
PL-CORE-G7 5000-827 L15 H1 ¹⁾	F	854141000000	18-04-2022	4052899534629
PL-CORE-G7 5000-830 L15 H1 ¹⁾	E	854141000000	18-04-2022	4052899534643
PL-CORE-G7 5000-835 L15 H1 ¹⁾	E	854141000000	18-04-2022	4052899534667

Termékcsalád adatlap

Termékmegnevezés	Energy efficiency class [GMS]	Logisztikai adatok	Environmental information Information according Art. 33 of EU Regulation (EC) 1907/2006 (REACH)	
		Commodity code	Date of Declaration	Primary Article Identifier
PL-CORE-G7 5000-840 L15 H1 ¹⁾	E	854141000000	18-04-2022	4052899534681
PL-CORE-G7 5000-935 L15 H1 ¹⁾	F	854141000000	18-04-2022	4052899534742
PL-CORE-G7 5000-940 L15 H1 ¹⁾	F	854141000000	18-04-2022	4052899534766

Termékmegnevezés	Candidate List Substance 1	Declaration No. in SCIP database
PL-CORE-G7 2000-827 L15 H1 ¹⁾	No declarable substances contained	No declarable substances contained
PL-CORE-G7 2000-830 L15 H1 ¹⁾	No declarable substances contained	No declarable substances contained
PL-CORE-G7 2000-835 L15 H1 ¹⁾	No declarable substances contained	No declarable substances contained
PL-CORE-G7 2000-840 L15 H1 ¹⁾	No declarable substances contained	No declarable substances contained
PL-CORE-G7 2000-927 L15 H1 ²⁾	No declarable substances contained	No declarable substances contained
PL-CORE-G7 2000-930 L15 H1 ¹⁾	No declarable substances contained	No declarable substances contained
PL-CORE-G7 2000-935 L15 H1 ¹⁾	No declarable substances contained	No declarable substances contained
PL-CORE-G7 2000-940 L15 H1 ¹⁾	No declarable substances contained	No declarable substances contained
PL-CORE-G7 3000-827 L15 H1 ¹⁾	No declarable substances contained	No declarable substances contained
PL-CORE-G7 3000-830 L15 H1 ¹⁾	No declarable substances contained	No declarable substances contained
PL-CORE-G7 3000-835 L15 H1 ¹⁾	No declarable substances contained	No declarable substances contained
PL-CORE-G7 3000-840 L15 H1 ¹⁾	No declarable substances contained	No declarable substances contained
PL-CORE-G7 3000-927 L15 H1 ²⁾	No declarable substances contained	No declarable substances contained
PL-CORE-G7 3000-930 L15 H1 ¹⁾	No declarable substances contained	No declarable substances contained
PL-CORE-G7 3000-935 L15 H1 ¹⁾	No declarable substances contained	No declarable substances contained
PL-CORE-G7 3000-940 L15 H1 ¹⁾	No declarable substances contained	No declarable substances contained
PL-CORE-G7 5000-827 L15 H1 ¹⁾	No declarable substances contained	No declarable substances contained
PL-CORE-G7 5000-830 L15 H1 ¹⁾	No declarable substances contained	No declarable substances contained
PL-CORE-G7 5000-835 L15 H1 ¹⁾	No declarable substances contained	No declarable substances contained
PL-CORE-G7 5000-840 L15 H1 ¹⁾	No declarable substances contained	No declarable substances contained

Termékcsalád adatlap

Termékmegnevezés	Candidate List Substance 1	Declaration No. in SCIP database
PL-CORE-G7 5000-935 L15 H1 ¹⁾	No declarable substances contained	No declarable substances contained
PL-CORE-G7 5000-940 L15 H1 ¹⁾	No declarable substances contained	No declarable substances contained

¹⁾ Modules perfectly matched to OSRAM OPTOTRONIC LED drivers (see relevant table)/For current photometric data and important safety, installation and application information (see www.osram.com/led-systems),/All the technical parameters apply to the entire module. In view of the complex manufacturing process for light emitting diodes, the typical values given above for the technical LED parameters are merely statistical values that do not necessarily correspond to the actual technical parameters of an individual product; individual products may vary from the typical values/Tolerance for optical and electrical data: +/-10%

²⁾ Modules perfectly matched to OSRAM OPTOTRONIC LED drivers (see relevant table)/For current photometric data and important safety, installation and application information (see www.osram.com/led-systems),/All the technical parameters apply to the entire module. In view of the complex manufacturing process for light emitting diodes, the typical values given above for the technical LED parameters are merely statistical values that do not necessarily correspond to the actual technical parameters of an individual product; individual products may vary from the typical values/Tolerance for optical and electrical data: +/-10%/OSRAM is not liable for errors in luminaires design and assembly

³⁾ 120°

Termékcsalád adatlap

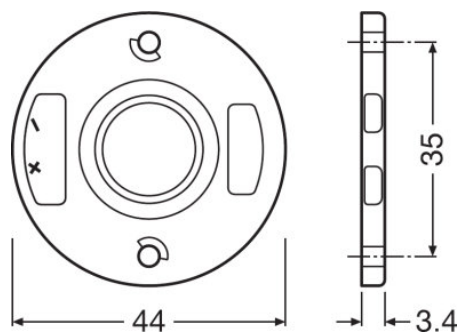

PL-CORE-G7 3000







Használati tanácsok

További részletes alkalmazási információkat és grafikákat a termék adatlapján talál.

Sales and Technical Support

Sales and Technical Support www.osram.com

Download Data

File	
	Addon Technical Information PrevaLED Core G7 Overview
	Certificates ENEC Certificate PL CORE G7
	Declarations of conformity PL CORE G7 CE 3610978 150322
	CAD data PL CORE G7 L15 H1 IGS 150520
	CAD data PL CORE G7 L15 H1 STEP 150520
	CAD Data 2-dim PL CORE G7 L15 H1 CAD2PDF 150520
	CAD data 3-dim PL CORE G7 L15 H1 CAD3PDF 150520

Termékcsalád adatlap

Ecodesign regulation information:

Separate control gear and light sources must be disposed of at certified disposal companies in accordance with Directive 2012/19/EU (WEEE) in the EU and with Waste Electrical and Electronic Equipment (WEEE) Regulations 2013 in the UK. For this purpose, collection points for recycling centres and take-back systems (CRSO) are available from retailers or private disposal companies, which accept separate control gear and light sources free of charge. In this way, raw materials are conserved and materials are recycled.

Logisztikai adatok

Termékkód	Termékmegnevezés	Csomagolás (darab/egység)	Méretek (hosszúság x szélesség x magasság)	Térfogat	Bruttó súly
4052899534308	PL-CORE-G7 2000-827 L15 H1	Karton 40	375 mm x 263 mm x 38 mm	3.75 dm ³	807.00 g
4052899534322	PL-CORE-G7 2000-830 L15 H1	Karton 40	375 mm x 263 mm x 38 mm	3.75 dm ³	807.00 g
4052899534346	PL-CORE-G7 2000-835 L15 H1	Karton 40	375 mm x 263 mm x 38 mm	3.75 dm ³	807.00 g
4052899534360	PL-CORE-G7 2000-840 L15 H1	Karton 40	375 mm x 263 mm x 38 mm	3.75 dm ³	807.00 g
4052899534384	PL-CORE-G7 2000-927 L15 H1	Karton 40	375 mm x 263 mm x 38 mm	3.75 dm ³	807.00 g
4052899534407	PL-CORE-G7 2000-930 L15 H1	Karton 40	375 mm x 263 mm x 38 mm	3.75 dm ³	807.00 g
4052899534421	PL-CORE-G7 2000-935 L15 H1	Karton 40	375 mm x 263 mm x 38 mm	3.75 dm ³	807.00 g
4052899534445	PL-CORE-G7 2000-940 L15 H1	Karton 40	375 mm x 263 mm x 38 mm	3.75 dm ³	807.00 g
4052899534469	PL-CORE-G7 3000-827 L15 H1	Karton 40	375 mm x 263 mm x 38 mm	3.75 dm ³	807.00 g
4052899534483	PL-CORE-G7 3000-830 L15 H1	Karton 40	375 mm x 263 mm x 38 mm	3.75 dm ³	807.00 g
4052899534506	PL-CORE-G7 3000-835 L15 H1	Karton 40	375 mm x 263 mm x 38 mm	3.75 dm ³	807.00 g
4052899534520	PL-CORE-G7 3000-840 L15 H1	Karton 40	375 mm x 263 mm x 38 mm	3.75 dm ³	807.00 g
4052899534544	PL-CORE-G7 3000-927 L15 H1	Karton 40	375 mm x 263 mm x 38 mm	3.75 dm ³	807.00 g
4052899534568	PL-CORE-G7 3000-930 L15 H1	Karton 40	375 mm x 263 mm x 38 mm	3.75 dm ³	807.00 g
4052899534582	PL-CORE-G7 3000-935 L15 H1	Karton 40	375 mm x 263 mm x 38 mm	3.75 dm ³	807.00 g
4052899534605	PL-CORE-G7 3000-940 L15 H1	Karton 40	375 mm x 263 mm x 38 mm	3.75 dm ³	807.00 g

Termékcsalád adatlap

Logisztikai adatok

4052899534629	PL-CORE-G7 5000-827 L15 H1	Karton 40	375 mm x 263 mm x 38 mm	3.75 dm ³	807.00 g
4052899534643	PL-CORE-G7 5000-830 L15 H1	Karton 40	375 mm x 263 mm x 38 mm	3.75 dm ³	807.00 g
4052899534667	PL-CORE-G7 5000-835 L15 H1	Karton 40	375 mm x 263 mm x 38 mm	3.75 dm ³	807.00 g
4052899534681	PL-CORE-G7 5000-840 L15 H1	Karton 40	375 mm x 263 mm x 38 mm	3.75 dm ³	807.00 g
4052899534742	PL-CORE-G7 5000-935 L15 H1	Karton 40	375 mm x 263 mm x 38 mm	3.75 dm ³	807.00 g
4052899534766	PL-CORE-G7 5000-940 L15 H1	Karton 40	375 mm x 263 mm x 38 mm	3.75 dm ³	807.00 g

The mentioned product code describes the smallest quantity unit which can be ordered. One shipping unit can contain one or more single products. When placing an order, for the quantity please enter single or multiples of a shipping unit.

References / Links

For more information on the multi-level guarantee and the terms and conditions of the guarantee visit

▶ www.osram.com/system-guarantee

Lemondás

A változtatás jogát fenntartjuk. Hibák és mulasztások kizárva. Mindig győződjön meg arról, hogy a legújabb kiadást használja.